

Report of Strategic Policy Manager

Subject: Proposed designation of Cresswell Quay Conservation Area

Purpose of Report

This report seeks approval to designate a Conservation Area within Cresswell Quay as shown on the map in Appendix A. A statutory notice be placed in a local newspaper and London Gazette is attached at Appendix B.

This report also seeks approval to publish a Report of Consultation, attached at Appendix C. An Integrated Assessment which considers the potential impacts of the designation regarding Equality, Socio-Economic Duty, Welsh Language Standards, Biodiversity Duty and the Well-Being of Future Generations Act is in Appendix D.

Background

The National Park Authority agreed on 24 July 2024 to undertake consultation and engagement for the designation of a Conservation Area at Cresswell Quay. Public consultation on the proposed designation was undertaken over an eight-week period from 30 July to 23 September 2024. In terms of public consultation, letters were delivered to all properties within the proposed conservation area, local Members, Town and Community Councils and statutory consultees. During this consultation period, officers also engaged with members of the local Town and Community Councils, held a drop-in engagement event at Pysgah Chapel and attended local shows, including the Pembroke Town and Country Show and the County Show to raise awareness.

A total of 17 responses were received to the consultation which were supportive of the Conservation Area designation. There was no opposition to the designation. A Report of Consultation is attached at Appendix C.

As a result of the engagement and consultation, it was suggested by two representors that the Conservation Area designation should be extended to include an additional area of woodland on the northern bank of the estuary. This change has been made to the boundary of the Conservation Area. A factual update to the map has also been made to indicate a listed building adjacent to the pub.

The designation of a conservation area at Cresswell Quay would recognise the special architectural and historic interest of the village and would ensure that future development either preserves or enhances the character and appearance of the conservation area. The designation would introduce controls over the demolition of buildings which would require conservation area consent and affords greater protection of works to trees. Officers consider that part of the special interest of

Cresswell Quay is the relationship between the village, the estuary and its wooded setting, which is unusual in a Pembrokeshire context.

Legal Background

The focus of this report is on Conservation Areas, which include unlisted and listed buildings which make a major contribution to the historic environment. Local planning authorities have the power (under Section 69 of the Planning (Listed Buildings and Conservation Areas) Act 1990) to designate as conservation areas, any area of special architectural or historic interest. They represent the settlements of greatest architectural and historic importance within the National Park and are a key and finite resource.

Section 69 of the Planning (Listed Building and Conservation Areas) Act 1990 imposes a duty on Local Planning Authorities to review these conservation areas from time to time.

The Historic Environment (Wales) Act 2023 will come into force on 4 November 2024 and after this date, references to the Planning (Listed Building and Conservation Areas) Act 1990 will be replaced with a reference to the 2023 Act.

Programme

To date, the Conservation Areas within the National Park have been designated in-house. However, Cresswell Quay is the home of the Buildings Conservation Officer and to avoid any potential conflict of interest or wider public misconception, the public consultation was undertaken by Linda Jones of Babb Architects, Whitland and Emily Holder, Conservation Assistant, supported by members of the Strategic Policy team.

A Conservation Area Appraisal and Management Plan is being prepared by Babb Architects and will be reported to NPA in early 2025. The documents will be consulted upon, prior to adoption as supplementary planning guidance. All Conservation Areas are regularly reviewed.

Legal Considerations

These are dealt with in the body of the report.

Financial considerations

The Authority has sufficient budget for the external consultant, consultation and engagement.

Welsh language considerations

Appendix D, Integrated Assessment (stage 2) considers the impacts of the proposal on the use of the Welsh language. The process of designating a conservation area, including consultation and engagement has been, and will continue to be carried out

in accordance with the requirements of the Welsh Language Standards (Welsh Language Measure (Wales) 2011).

The consultation questionnaire contained a specific question on the Welsh language impact of the proposal. All participants who participated in the survey responded to the question with many respondents feeling that there would be no effect to the Welsh language. Respondents also commented that bilingual signage at specific historical sites in Cresswell Quay would provide a positive addition to the area and support the Welsh language. The summary of responses is available in Appendix C.

The proposal is considered to have a positive impact on Welsh language and culture. The designation of a conservation area would preserve and enhance buildings of special architectural and historic interest, thereby preserving the historic and cultural identity of an area, including Welsh and Pembrokeshire traditions and heritage.

Biodiversity Duty and Decarbonisation

In summary, the proposals are likely to have a positive effect on the Authority's biodiversity duty and a neutral impact its decarbonisation agenda.

Equality, Socio- Economic Duty, Human Rights

Consultation and a community engagement has taken place with the local community in Cresswell Quay, at a drop in style engagement event, held at Pisgah Chapel in August. This enabled local residents to have an opportunity to ask officers questions and discuss views on the area of the proposed Conservation Area designation. The local Pisgah Chapel was identified as a suitable venue which was accessible to all, including those with disabilities. Information on the Conservation Area consultation was also promoted at local shows during August. The responses from the consultation and engagement have been positive and have informed an amendment to the boundary of the Conservation Area designation.

The planning system seeks to progress legitimate aims by managing the development and use of land in the public interest to contribute to achieving sustainable development. It reconciles the needs of development and conservation, securing economy, efficiency, and amenity in the use of land, and protecting natural resources and the historic environment. Human rights under Articles 1 (right to peaceful enjoyment to property), 8 (right to respect for the home, private and family life) and 14 (right to equality), are the most relevant ones. Proportionality means that the measure which interferes with the right must strike a fair balance between the aim and the right which it interferes with.

Well-being of Future Generations (Wales) Act

The proposals fit well within the Well-being Goals and the 5 Ways of Working.

Conclusion

The consultation and engagement showed support for a Conservation Area designation at Cresswell Quay. The proposed boundary of the designation has been amended to take account of representations made (see map in Appendix A) and is recommended for approval and adoption.

Recommendation

Members are asked to approve:

1. That Cresswell Quay is designated a Conservation Area, as set out on the map attached at Appendix A and that statutory notices be placed in the local press and London Gazette (see Appendix B).
2. The publication of the Report of Consultation, attached at Appendix C.

A draft appraisal and management plan will be the focus of a further report to Members in early 2025.

**Ardal Gadwraeth Cei Cresswell
Dynodedig
/Designated Cresswell Quay
Conservation Area**

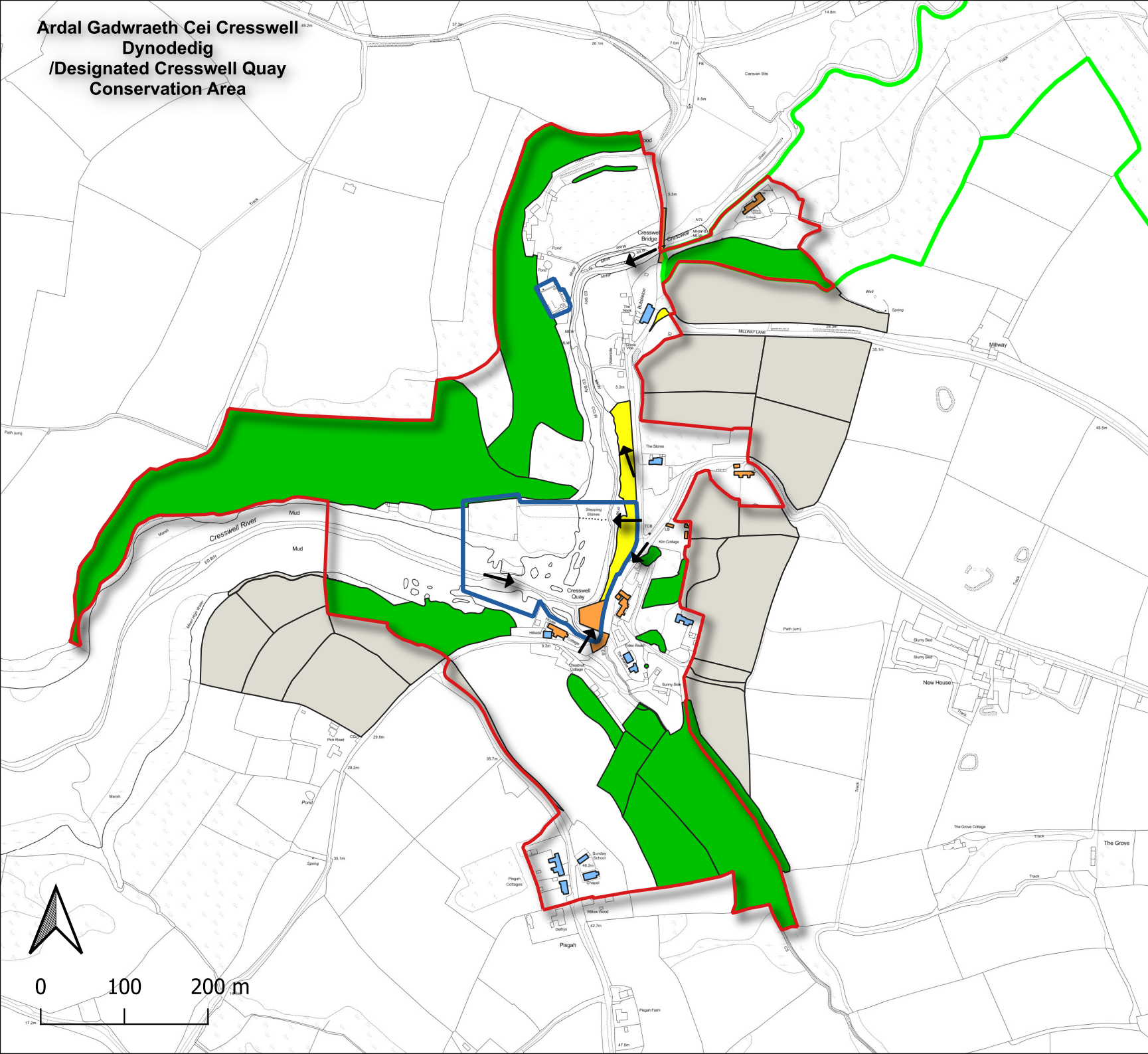

-  Golygfa allweddol/
Key Views
-  Parciau a Gerddi Hanesyddol
Cofrestredig/Registered
Historic Parks
and Gardens
-  Henebion Rhestredig/
Scheduled Ancient Monument
-  Ardal Gadwraeth Ddynodedig/
Designated Conservation Area
-  Adeiladau Rhestredig/
Listed Buildings
-  Gorchymyn Cadw Coed/
Coed sy'n bwysig i'r lleoliad/
Tree Preservation Order/
Trees Important to Setting
-  Ardaloedd Agored hanfodol/
Essential Open Areas
-  Adeiladau ynni positif/
Positive Buildings
-  Ardaloedd sy'n bwysig i osodiad a
chymeriad yr ardal gadwraeth
afaithedig/
Areas Important to Setting
and Character of The
Proposed Conservation Area

© Crown copyright and database rights Ordnance Survey AC0000810561, 2024/Hawlfraint y Goron a hawliau cronfa ddata Arolwg Ordnans AC0000810561, 2024

Designated Historic Asset GIS Data, The Welsh Historic Environment Service (Cadw), 2024, licensed under the Open Government Licence/Data GIS ar Asedau Hanesyddol Dynodedig, Gwasanaeth Amgylchedd Hanesyddol Cymru (Cadw), 2024, wedi'u trwyddedu o dan Drwydded Llywodraeth Agored <http://www.nationalarchives.gov.uk/doc/open-government-licence/version/3/>

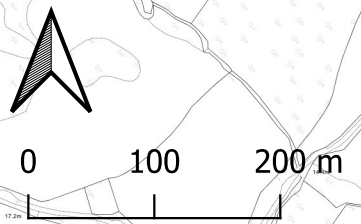

AWDURDOD PARC CENEDLAETHOL ARFORDIR PENFRO

DEDDF CYNLLUNIO (ADEILADAU RHESTREDIG AC ARDALOEDD CADWRAETH) 1990

Ardal Gadwraeth Cei Cresswell

Hysbysir drwy hyn bod Awdurdod Parc Cenedlaethol Arfordir Penfro wedi dynodi Ardal Gadwraeth yn Cei Cresswell bresennol yn unol â Deddf Cynllunio (Adeiladau Rhestredig ac Ardaloedd Cadwraeth) 1990. Prif effeithiau'r dynodiad yw:

- a) Rhaid i ni dalu sylw arbennig wrth gyflawni ein dyletswyddau fel yr Awdurdod Cynllunio Lleol i fuddioldeb cadw neu wella cymeriad neu ymddangosiad yr ardal; a rhaid i'r Awdurdod baratoi a chyhoeddi cynigion ar gyfer diogelu a gwella'r ardal;
- b) Rhaid i ni roi cyhoeddusrwydd i geisiadau cynllunio ar gyfer datblygiad sy'n effeithio ar gymeriad neu ymddangosiad yr ardal; a chymryd i ystyriaeth y sylwadau a dderbyniwyd yn sgîl y cyhoeddusrwydd hwnnw; a
- c) Rhaid ceisio caniatâd i ddymchwel adeiladau penodol a rhoi gwybod ymlaen llaw am unrhyw fwriad i dorri coeden, brigdorri, tocio, diwreiddio neu ddinistrio unrhyw goeden.

Am fanylion llawn, gan gynnwys eithriadau i'r gofynion hyn, cysyllter â ni yn y cydeiriad isod.

Gellir cael golwg ar y plan sy'n dangos yr ardal sydd wedi'i dynodi yn Swyddfa Awdurdod Parc Cenedlaethol Arfordir Penfro, Parc Llanion, Doc Penfro, Sir Benfro, SA72 6DY (ffôn: 01646 624800)

Tegryn Jones- Prif Weithredwr (Swddog Parc Cenedlaethol)

23 Hydref 2024

PEMBROKESHIRE COAST NATIONAL PARK AUTHORITY

PLANNING (LISTED BUILDINGS & CONSERVATION AREAS) ACT 1990

Cresswell Quay Conservation Area

Notice is hereby given that the Pembrokeshire Coast National Park Authority has designated a Conservation Area at Cresswell Quay in accordance with the Planning (Listed Buildings and Conservation Area) Act 1990. The principle effects of the designation are that:

- a) We must pay special attention in carrying out our duties as Local Planning Authority to the desirability of preserving or enhancing the character or appearance of the area; and must prepare and publish proposals for its preservation and enhancement;
- b) We must give publicity to planning applications for development affecting the character or appearance of the area; and take into account representations received as a result; and
- c) Consent must be sought for the demolition of certain buildings and prior notification given of any intention to cut down, top, lop, uproot or destroy any tree.

For full details, including exceptions to these requirements, please contact us at the address below.

A map showing the area subject to designation may be inspected at the Pembrokeshire Coast National Park Authority, Llanion Park, Pembroke Dock, Pembrokeshire SA72 6DY (tel: 01646 624800)

Tegryn Jones – Chief Executive (National Park Officer)

23 October 2024



**Parc Cenedlaethol
Arfordir Penfro**

**Pembrokeshire Coast
National Park**

Pembrokeshire Coast National Park Authority
Report of Consultation

Consultation on the proposed Conservation Area
at Cresswell Quay

October 2024

1. Introduction

1.1 Members of The Pembrokeshire Coast National Park Authority (PCNPA) agreed on 24 July 2024 to undertake public consultation and engagement regarding a Conservation Area designation at Cresswell Quay. Cresswell Quay is one of the most scenic villages within the National Park and is highly significant as a very early coal port, retaining several buildings of architectural importance.

2. Engagement and Consultation

2.1 Public consultation on the proposed designation was undertaken over an eight-week period from 30 July to 23 September 2024.

2.2 Prior to the formal public consultation, informal engagement was undertaken with key landowners. An engagement session was held on 16 July 2024 for local Members and representatives from Cresselly, Martletwy and Jeffreyston Community Councils.

2.3 The consultation was published on the Pembrokeshire Coast National Park Authority's website on 30 July 2024. The following documents were available:

- Consultation letter: [Consultee-Letter-003.docx \(live.com\)](#)
- Map outlining the boundary of proposed Conservation Area: [Bilingual-Map-of-Cresswell-Quay-Proposed-Conservation-Area-for-consultation.pdf \(pembrokeshirecoast.wales\)](#)
- Leaflet providing further information on Conservation Areas: [Leaflet-on-Cresswell-Quay-CA.pdf \(pembrokeshirecoast.wales\)](#)

Respondents were invited to submit their views on the proposed designation through an online questionnaire. An email address and postal address was provided for respondents to submit representations in writing.

2.4 A letter regarding the consultation was circulated to:

- Local residents within the proposed Conservation Area in Cresswell Quay
- Local Members for the area
- Carew, Jeffreyston and Martletwy Community Councils
- Statutory consultees, including Natural Resources Wales, Dwr Cymru Welsh Water, BT, National Grid, Heneb, Cadw, Pembrokeshire County Council and The Coal Authority.

The PCNPA's Communications team circulated a press release and advertised the consultation on social media platforms.

2.5 During the consultation period, an engagement event was held on Thursday 8 August from 3pm to 7pm at Pisgah Chapel. 10 members of the public attended which provided the opportunity to ask questions regarding Conservation Area status and the proposed boundary.

2.6 Planning Officers from the PCNPA attended the following local shows to engage with members of the public regarding the proposal:

- Pembroke Town and Country Show, 7 August
- Pembrokeshire County Show, 14 and 15 August

Planning Officers also raised awareness of the consultation at the Planning Agents forum meeting on 12 September.

3. Consultation responses

3.1 A series of five questions were constructed to encourage engagement from residents and members of the public. The questions were based around key aspects of the proposed Conservation Area for Cresswell Quay, including the accuracy of boundary perimeter, effects of imposing a new Conservation Area in Cresswell Quay including effects on Welsh language, and views on the implication of a Conservation Area in Cresswell Quay. An open-ended question was also included to allow members of the public to provide their own observations on the proposal.

3.2 A total of 17 responses were received to the consultation, 14 via the online questionnaire and three email representations.

Question 1 - Which of the following statements apply to you?

Summary of responses

Question 1 asked the respondent what their connection was to Cresswell Quay. 50% of respondents selected they live in or near Cresswell Quay, while the other 50% selected they live in Pembrokeshire and enjoy visiting Cresswell Quay. Respondents provided a range of views drawing from knowledge of the local history and nature of the area.

4. Summary of responses by question

4.1 A summary analysis of the key findings for each consultation is set out below. Few respondents chose not to provide a direct answer but provided comments.

Question 2 - Which of the following describes your views on the Conservation Area proposal?

Summary of responses

All respondents that participated in the survey submitted responses for this question. An overwhelming majority of respondents (86%) support the creation of a Conservation area in Cresswell Quay and 14% of respondents expressed they did not have a strong view. There was no opposition to the Conservation Area proposal from responses received. In questions five and seven most respondents commented on the importance of protecting the heritage, biodiversity and natural beauty of the area, and feel the proposed Conservation Area of Cresswell Quay is a positive way to implement protection of the area.

Officer response

Support noted.

Question 3 - Do you think we have drawn the boundary correctly?

Summary of responses

71% of respondents agreed that the boundary has been drawn correctly by the Authority and 21% of respondents did not have a view on this question. One respondent (equating to 7% of respondents) voiced that the boundary was not drawn correctly. An additional comment was received at the engagement event for Town and Community Councils that the proposed boundary was incorrect.

Officer response

Comments noted, see officer response to Question 4.

Question 4 - If you have answered No to question 3 – how do you think we should amend the boundary? (please feel free to send us a map with an amended boundary)

Summary of responses

One comment was received by the questionnaire respondent who had stated the boundary line was not accurate in question three. They suggested an extension of the boundary to include an area of woodland subject to Tree Preservation Orders (TPOs) further down the estuary on the northern bank. The same view was expressed by an individual at the engagement event for Town and Community Councils.

Officer response

Most of the area referred to is covered by TPOs, but the inclusion of the wooded area within the Conservation Area would provide additional protections and help protect the setting and the character of Cresswell Quay. Agree to amend boundary (see maps in the Appendix with the map on the left showing the proposed Conservation Area boundary that was subject to consultation and the map on the right showing the revisions Conservation Area boundary following consultation).

Question 5 - Are there any special features within Cresswell Quay that you think should be picked up in a Management Plan for the area?

Summary of responses

78.6% of respondents provided feedback for this question. The majority of respondents responded that the special features within Cresswell Quay included the general heritage, natural beauty and biodiversity of the area. Some respondents have suggested the old Quays should be restored, maintained and highlighted for public awareness. Other areas of importance noted by respondents include: Coal fold and coal manager's office; five springs; old crossing point for ox pulled coal carts; quays; remains of lime kiln (possibly gone); 'monastery' ruin at New Briton; spring in Scotland wood behind New Briton, biodiverse rich swampy meadow in front of New Briton; all buildings which previously housed people with tradesmen artisans; oak trees in Scotland wood once all cut down for pit props in WW1; Cresswell River; lane behind the pub which leads up the valley towards Freestone used historically to bring coal in carts from bell pits in the valley.

Respondents have also raised concerns about the current situation in the area which is echoed in the open-ended question at the end of the survey. Concerns raised include required maintenance to stepping stones, increased traffic, congestion and advertisement around the pub and waterfront, and concerns over water quality of the river effected by agricultural practices. One respondent has voiced that the area does not require any change currently.

Officer response

- **Congestion and parking**

Highway matters such as congestion are outside the remit of this Conservation Area appraisal and are within the remit of Pembrokeshire County Council as the Highway Authority. Street works and highway improvements such as the introduction of double yellow lines and marked parking areas can impact on the visual appearance of historic areas. The preferred option would be to manage traffic issues without resorting to permanent highways works.

Assuming the proposed Conservation Area is adopted then a prime consideration in alterations to the highway will be whether the physical measures preserve or enhance the character or appearance of the conservation area, while meeting operational and safety requirements. This does not mean that things cannot change and improvements which help safety cannot be made but it does mean that the impact of the Conservation Area status should also be considered. The other designations which Cresswell Quay has, such as SSSI and Scheduled Ancient Monument status to the quay itself also bring with them environmental and conservation considerations which need to be borne in mind.

- **Commercialisation of Cresswell Quay**

Any proposed commercialism of the area which would be subject to planning permission, would, with a Conservation Area in place, have to preserve or enhance the character or appearance of the conservation area as well as meet other planning requirements.

- **Maintenance**

Maintenance of land and structures are normally the responsibility of the owners.

Issues regarding the level of maintenance being carried out on structures and land within the Cresswell Quay is outside the remit of this Conservation Area Appraisal.

The quays and stepping stones are part of the Scheduled Ancient Monument for Cresswell Quay. Consent is required from Cadw for most works to these structures, including repairs. Generally, repairs should be the minimum necessary to stabilize and conserve the monument both for its long-term survival and to meet the needs of continuing use.

- **Old quays/ history highlighted**

The Conservation Area appraisal will contain a section summarising the history of Cresswell Quay. This will be produced bilingually.

Providing interpretation on site of the history of Cresswell Quay is not part of the Conservation Area appraisal, but the suggestion will be raised within the PCNPA.

- **Right of way**

No rights of way will be affected by the proposed Conservation Area Management Plan.

- **Water quality**

Water quality and its monitoring is outside the remit for the Conservation Area Management Plan and instead is the responsibility of NRW.

Question 6 - What effects (whether positive or adverse) do you think the proposed Conservation Area would have on the Welsh language, including opportunities for people to use Welsh and on treating the Welsh language no less favourably than English? How could positive effects be increased, or negative effects be mitigated?

Summary of responses

All respondents who participated in the survey provided a response for question six. Many respondents feel that there would be no effect to the Welsh Language if the proposed Conservation area is designated. Four respondents feel that the implementation of bilingual signage at specific historical sites in Cresswell Quay will provide a positive addition to the area and will support the Welsh language. A few comments from respondents have suggested concerns regarding changing the town name to a Welsh translated name. One respondent feels unsure of the effects of the

proposed Conservation Area on Welsh Language and another respondent did not suggest any viewpoint on this question.

Officer response

The Conservation Area Management Plan will be produced bilingually and available in Welsh and English on the website.

Providing interpretation on site of the history of Cresswell Quay is not part of the Conservation Area appraisal we are currently carrying out, but the suggestion will be raised within the PCNPA.

The proposed Conservation Area Management Plan will not affect any opportunities for Welsh speaking groups/learner groups to meet at the pub or arrange guided walks.

The importance of the local dialect is recognised, but it will not be affected by the Conservation Area Management Plan.

The Conservation Area Management Plan will not propose any name changes.

Question 7 - Please let us know if you have any further comments

Summary of responses

50% of respondents who participated in the survey have provided further comments in question seven. Respondents have highlighted the importance of the pub and how it has maintained its historic character. Concerns that have previously been mentioned in question 6 have been raised again in question seven. Increased noise, food outlets and advertisements in the area is mentioned as an area of concern that respondents are keen for the Authority to address as respondents feel this is negatively impacting Cresswell Quay. Several comments received voiced concerns over the increase of traffic and its impact on pedestrian safety in the area, particularly around the Quay. Other respondents have raised concerns over the impact of extra traffic and are concerned that this may result in yellow lines, parking restrictions and paid parking being implemented in the area. Many respondents feel protecting the history and nature of the area is of vital importance and welcome the proposed Conservation Area in Cresswell Quay. A recently felled Chestnut tree was also raised as a concern for its effect on the original beauty and nature of the area.

Officer response

- **Felling of healthy trees**

The felling of trees will come under more control with the introduction of Conservation Area status. Anyone proposing to cut down, top, or lop a tree in a conservation area must give the local planning authority six weeks' notice, during which time the authority can decide whether to protect that tree with a Tree Preservation Order (TPO).

- **Traffic**

Pembrokeshire County Council is the Highway Authority and comments regarding parking and congestion, including removal of traffic cones from the Quay falls under the responsibility of Pembrokeshire County Council.

Other feedback

Waste left by overnight campers/lack of WC facilities an issue (mentioned by two people in drop-in session)

Open area maintenance – possible tensions between community use and wildlife habitat.

Officer response

Wild camping is not permitted in the National Park without prior permission from the landowner. Camping in car parks or on roadside verges in the National Park is not permitted. Illegal waste dumping should be reported to Pembrokeshire County Council. The Authority acknowledges there may be conflicting use of open space and education is key to ensure open space can be enjoyed whilst ensuring habitats are protected.

Organisation Responses

Three responses were received from organisations regarding the proposed Conservation Area for Cresswell Quay, two organisations have remained neutral to the proposal advising no effects were apparent to their organisations while the organisation has stated it supports the proposed Conservation Area.

5. Summary of Amendments

The majority of consultation responses support the creation of a Conservation Area in Cresswell Quay. There was no opposition to the proposed designation of a

Conservation Area. The boundary of the Conservation Area has been extended to include an area of woodland on the northern boundary of the estuary. The maps in the Appendix shows the boundary of the Conservation Area that was subject to consultation and the map on the right shows the amended boundary of the Conservation Area for designation.

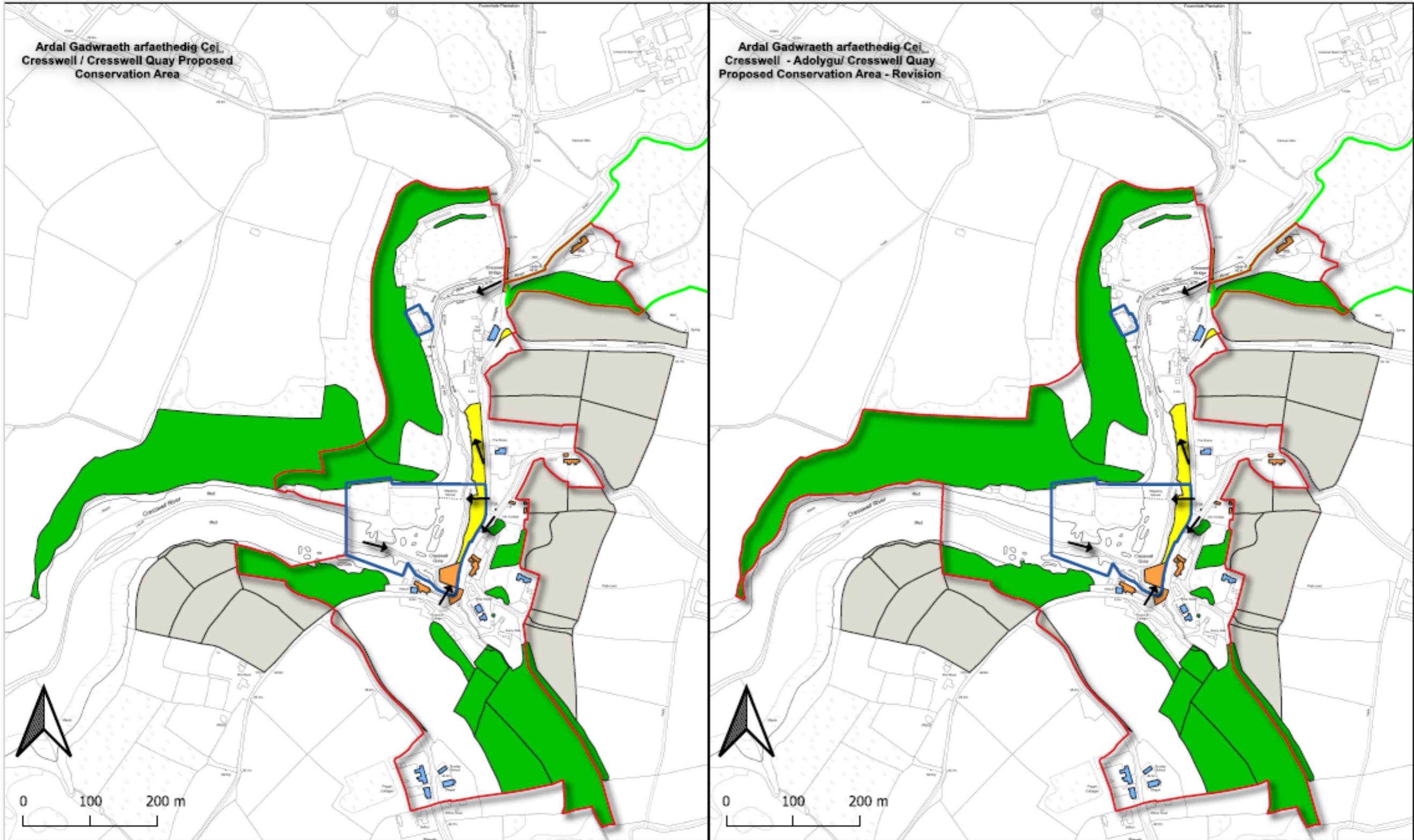

<p>→ Golygfya allweddol/ Key Views</p> <p>Parciau a Gerddi Hanesyddol Cofrestredig/Registered Historic Parks and Gardens</p>	<p>Henebion Rhestredig/ Scheduled Ancient Monument</p> <p>Ardal Gadwraeth arfaethedig/ Proposed Conservation Area</p> <p>Adeiladau Rhestredig/ Listed Buildings</p>	<p>Gorchymyn Cadw Coed/ Coed sy'n bwysig i'r lleoliad/ Tree Preservation Order/ Trees Important to Setting</p> <p>Ardaloedd Agored hanfodol/ Essential Open Areas</p>	<p>Adeiladau ynni positif/ Positive Buildings</p> <p>Ardaloedd sy'n bwysig i osodiad a chymeriad yr ardal gadwraeth arfaethedig/ Areas Important to Setting and Character of The Proposed Conservation Area</p>
--	---	---	---

© Crown copyright and database rights Ordnance Survey
AC0200610561, 2024/© Hysfoddi y Gorn a hawliau cronfa
ddata Arlog Ordnans AC0000610561, 2024

Designated Historic Asset GIS Data, The Welsh Historic
Environment Service (Cadw), 2024, licensed under the Open
Government Licence/Data GIS ar Asedau Hanesyddol
Dyrodolig, Gwasaneth Anysychedd Hanesyddol Cymru
(Cadw), 2024, wedi'i trwyddedu a dan Ddeddf
Llywodraeth Agored. <http://www.nationalarchives.gov.uk/doc/open-government-licence/version/2/>



BABB
ARCHITECTS



Pen Castell
Arfordir Penrhyn
Parkeiddio Cymru
National Park

PCNPA Integrated Assessment Template

Title of what is being Assessed: Designation of Cresswell Quay Conservation Area

Is this a staged Integrated Assessment: Yes, a Draft Integrated Assessment (part 1) was prepared in July when the proposal for designating the Conservation Area at Cresswell Quay was initiated. This assessment forms a part 2 review following the public consultation period and proposal for designating a Conservation Area at Cresswell Quay.

This document is a multi-purpose tool ensuring the appropriate steps are taken in our plan, policy and decisions making processes to:

- Comply with the Public Sector Equality Duty (we are required to assess equality impacts under the Welsh Specific duties.)
- Demonstrate that we have shown due regard to the need to reduce inequalities of outcome resulting from socio-economic disadvantage when taking strategic decisions under the Socio-Economic Duty.
- Ensure we are considering impact on Health and Well-being
- Ensure consideration of the Welsh Language Standards.
- Ensure we are considering the Section 6 Biodiversity Duty and wider decarbonisation considerations in our plans and decision-making processes.
- Ensure we are considering the Well-being Goals for Wales, 5 Ways of Working under the Well-being of Future Generations Act and any relevant future trends/ horizon scanning information.

Benefits of undertaking an Integrated Assessment:

- Gain a better understanding of those who may be impacted by the plan, decision, policy, or practice.
- Better meet differing needs and become more accessible and inclusive.
- Enable planning for success – identifies potential pitfalls and unintended consequences before any damage is done.
- Prevent poor decisions, or worse, having to reverse decisions, thus avoiding cost and reputational implications.
- Demonstrate decisions are thought through and have taken into account the views of those affected.
- Enable us to manage expectations by explaining the limitations within which we are working (e.g. budget)
- Help avoid risks and improve outcomes for individuals.
- Remove inappropriate or harmful practices and eliminate institutional discrimination.
- Ensure we put the Welsh and English Language on an equal footing.

- Ensure we are embedding biodiversity and decarbonisation considerations in everything that we do.

Section 1 – Details of the Strategic Plan, Policy, or Decision

Name of Strategic Plan, Policy or Decision being assessed	Designation of Conservation Area at Cresswell Quay.
Department/ Service Area	Planning
Officer Responsible for Impact Assessment	Name: Emma Gladstone (Stage 2, post consultation and designation)
Responsible Senior Manager	Name: Sara Morris Title: Director of Placemaking, Decarbonisation and Engagement
Timetable for the Assessment	A report to the National Park Authority on 24 July sought approval for a formal public consultation to designate a Conservation Area at Cresswell Quay. A stage 1 impact assessment was prepared in July. Consultation and engagement was conducted over an 8 week period from 30 July to 23 September 2024. A report to the National Park Authority in October will seek approval to designate a Conservation Area at Cresswell Quay. A draft Conservation Area Appraisal and Management Plan for Cresswell Quay will be prepared and presented to the National Park Authority in early 2025 for approval for formal public consultation.
Monitoring and Review of Assessment	See above under Timetable for the Assessment.
STAGE 2 (POSTPUBLIC CONSULTATION): Chief Executive Sign Off – Completed Assessment and	Sign off date: <i>Tegryn Jones</i> 08/10/2024

Summary/ Recommendations	
-------------------------------------	--

Section 2 – Aims and Overview of the Strategic Plan, Policy, or Decision

What is its proposed purpose?
<p>To designate a Conservation Area at Cresswell Quay. The purpose of a designated Conservation Area is to ‘preserve and enhance’ the special historic or architectural interest of an area and help ensure that future development has regard to that special interest.</p> <p>Conservation Areas are ‘areas of special architectural or historic interest, the character of which it is desirable to preserve or enhance’. Their introduction under the 1967 Civic Amenities Act resulted from the growing awareness that as well as individual buildings, trees and features, whole areas could be of interest and value.</p> <p>Cresswell Quay is considered appropriate for Conservation Area designation as it is one of the most scenic villages within the National Park and is highly significant as a very early coal port, retaining several buildings of architectural importance.</p>
Is it new or existing and under review?
<p>The Conservation Area designation at Cresswell Quay is new.</p>
What will change as a result of it and/or what changes are being proposed?
<p>Conservation area consent is required for the demolition of an unlisted building in a conservation area, with some exceptions. Applications for conservation area consent for demolition within a conservation area will require a heritage impact statement.</p> <p>Anyone proposing to cut down, top, or lop a tree in a conservation area must give the local planning authority six weeks’ notice, during which time the authority can decide whether to protect that tree with a Tree Preservation Order. This requirement does not apply to trees under a certain size, or those that are proven to be dead, dying, or dangerous.</p> <p>All planning applications within a conservation area must demonstrate that development has preserved or enhanced the character or appearance of the conservation area. Designation does not prevent development, but helps to ensure that it is appropriate in form, scale, material and design such that it would not harm the setting and would help to positively enhance the area’s unique character.</p>

What are its anticipated notable outcomes (positive and negative)?

Positive:

- The designation of a Conservation Area at Cresswell Quay would add additional protection and ensures that changes in the conservation area either preserve or enhance the character and appearance of the area. This will ensure new development is of good quality and protects important architectural features and buildings of historic interest.
- The additional protection of the historic environment ensures that proposals are compatible with the strategy of the Pembrokeshire Coast National Park Local Development Plan 2, the purposes of National Parks and the special qualities of the Pembrokeshire Coast National Park, which includes distinctive settlement character, rich historic environment and cultural heritage. The purposes of National Parks are to:
 - Conserve and enhance the natural beauty, wildlife, and cultural heritage of the area.
 - Promote opportunities for the public understanding and enjoyment of the special qualities of the Parks.The duty to foster the economic and social well-being of local communities within the National Park is in pursuit of those purposes.

Note that these policies and strategies have also been subject to a relevant Impact Assessment.

- The designation of a Conservation Area is the positive management of an area which could bring social, economic, cultural and environmental benefits. As stated in Planning Policy Wales “The historic environment is a finite, non-renewable and shared resource and a vital and integral part of the historical and cultural identity of Wales. It contributes to economic vitality and culture, civic pride, local distinctiveness and the quality of Welsh life. The historic environment can only be maintained as a resource for future generations if the individual historic assets are protected and conserved.” (paragraph 6.15).
- Consultation and engagement has taken place with the local community which has a positive impact on encouraging participation in public life.

Negative:

- Individual landowners who wish to demolish a building would be required to obtain Conservation Area Consent. No application fee is required for those proposals, however, costs may be incurred where a planning consultant is engaged.
- Individual landowners who propose to cut down, top, or lop a tree would be required to give the local planning authority six weeks’ notice.

Detail the budget implications relating to it?
The Authority has sufficient budget to cover an external consultant carrying out the assessment and preparation of the Appraisal and Management Plan, together with engagement and consultation costs.
Indicate which groups of people will be, or potentially could be, impacted upon by its implementation (e.g. service users, employees, volunteers, people living in particular communities)? Please include any equality or socio-economic disadvantaged groups likely to be affected
Residents and owners of properties in the designated conservation area at Cresswell Quay. Planning/Enforcement Officers. Members.
Is the policy related to, influenced by, or affected by other policies or areas of work (internal or external) and any assessments carried out on them?
Yes, the Local Development Plan 2 and its associated Assessments, i.e. Strategic Environmental Appraisal, Sustainability Appraisal, Habitats Regulations Assessment, Equalities Impact Assessment.

Section 3 – Considering the Evidence and Assessing Impact

This section considers what data, information, consultation, and engagement feedback has been reviewed as part of the plan, policy, or decision development process. Relevant information will then be used to assess potential impact of the plan, policy or decision and potential mitigating action needed. Gaps in data and knowledge are also noted.

Equality/ Socio Economic Disadvantage and Inequality of Outcomes/ Health Inequalities and Outcomes

Depending on what is being assessed you can either take a thematic approach or a group focused approach, please speak to the Performance and Compliance Co-ordinator to find out what approach will best suit what you are assessing.

If it is not suitable to include detailed evidence information, data, and engagement/ consultation feedback in the table itself, please attach this information as an Appendix and make summary reference to them in the table when needed.

Group focused Impact Approach

Protected Characteristics/ Socio Economic Disadvantage and Inequality of Outcomes/ Health and Well-being Outcomes and Inequalities	Do you have evidence or reason to believe that this will or may affect any of the following Protected Characteristics/ Socio Economic Disadvantage and Inequality of Outcome/ Health and Well-being Outcomes and Inequalities? Consider both positive and negative impacts. Reference relevant evidence and information from engagement feedback.	Response/ Mitigation/ Any additional actions needed
Age	<p>1. Adaptations to Buildings to Make them Accessible</p> <p>The designation of a conservation area at Cresswell Quay would recognise the special architectural and historic interest of the area. All development must either preserve or enhance the character and appearance of the conservation area. With regard to age,</p>	<p>1. The designation of the conservation area at</p>

	<p>there is an aging population in Pembrokeshire and a high proportion of older people live in the Cresswell Quay area. This may impact on the need for buildings to be adapted to be accessible to all. Within a Conservation Area, all development, including any adaptations to make buildings accessible would need to be of a good design which is sensitive to the character and appearance of the conservation area. This will ensure new development is of good quality and protects important architectural features and buildings of historic interest.</p> <p>All households in the designated Conservation Area were notified of the consultation by letter. An engagement event was held in the local Pysgah Chapel to ensure that information was accessible to all age groups. Information on the Conservation Area consultation was also be promoted at events including The Pembroke Town and Country Show and the Pembrokeshire County Show during August.</p> <p>Issue of impact of designation of conservation area and adaptations to make buildings accessible wasn't identified as issue or area of concern in terms of consultation responses.</p> <p>2. Traffic Safety</p> <p>Several comments received as part of the consultation voiced concerns over the increase of traffic and its impact on pedestrian safety in the area, particularly around the Quay. Traffic safety can be a particular area of concern in terms of safety of children.</p> <p>Local Development Plan 2</p> <p>Development proposals in the Conservation Area would be subject to planning permission and would be determined in accordance with the policies of Local Development Plan 2. Local Development Plan 2 was subject to an Equality Impact Assessment ¹ which screened all policies against potential impact on protected characteristics under the</p>	<p>Cresswell Quay will not prevent adaptations to make buildings accessible, it will mean that when proposing an adaptation they will need to be of good design and sensitive to character and appearance of the conservation area.</p> <p>2. Assuming the proposed Conservation Area is adopted then a prime consideration in alterations to the highway</p>
--	---	---

¹ <https://www.pembrokeshirecoast.wales/planning/planning-policy/local-development-plan-2/>

	<p>Equality 2010. The Authority considered relevant evidence to understand the likely or actual effect of policies and practices on protected groups.</p> <p>This included ensuring Local Development Plan policies do not unlawfully discriminate, identifying any adverse impacts on protected groups, considering how the policy or practice could better advance equality of opportunity and considering whether the policy would affect relations between different groups. Where negative impacts were identified mitigating action or explanatory information was provided.</p> <p>In terms of demonstrating 'due regard' the assessment was considered at distinct stages by Officers and Members in terms of the Preferred Strategy, consultation for the Local Development Deposit Plan and Focussed Changes. The Matters Arising Changes were screened for equality impacts, none of the proposed Matters Arising Changes were considered to result in any negative equality impacts for people with protected characteristics under the Equality Act 2010 and no further assessment was considered necessary.</p> <p>Planning Process</p> <p>The designation of a Conservation Area at Cresswell Quay will introduce controls on demolition with the requirement to obtain Conservation Area Consent. The Authority is also required to be notified regarding proposed works to trees. All proposals for development are required to demonstrate that the development either preserves or enhances the character and appearance of the conservation area. This can be achieved with good design.</p> <p>In relation to submitting the application for Conservation Area Consent there would be a period of engagement with those affected. This means there would be an opportunity for any person to submit observations on the proposal. This means that the process of introducing a Conservation Area would: -</p>	<p>will be whether the physical measures preserve or enhance the character or appearance of the conservation area, while meeting operational and safety requirements. This does not mean that things cannot change and improvements which help safety cannot be made but it does mean that the impact of the Conservation Area status should also be considered. The other</p>
--	---	--

- reduce the probability of the discrimination caused when members of the public do not receive information about changes that affect them or who feel that they do not have the ability to influence.
- require seeking the opinion of those who are affected.

The assessment of proposals could, however, lead to a refusal of consent. The planning system in Wales plays a crucial role in managing land use and development. Its purpose is to ensure the efficient and sustainable use of land while balancing the needs of development and conservation. This is particularly important in a National Park. Applicants can appeal the Authority's decision.

Census 2021 Data

	Output Area			
	W00003008		W00002974	
Age	#	%	#	%
Aged 15 years and under	51	21	39	13
Aged 16 to 24 years	15	6	15	5
Aged 25 to 34 years	20	8	20	7
Aged 35 to 49 years	38	16	37	12
Aged 50 to 64 years	54	23	81	27
Aged 65 years and over	60	25	108	36
Total	238	10	300	100

designations which Cresswell Quay has, such as SSSI and Scheduled Ancient Monument status to the quay itself also bring with them environmental and conservation considerations which need to be borne in mind.

Disability

1. Adaptations to Buildings to Make them Accessible

The designation of a conservation area at Cresswell Quay would recognise the special architectural and historic interest of the village. All development must either preserve or enhance the character and appearance of the conservation area. With regard to disability, access to buildings would need to be of a good design which is sensitive to the character and appearance of the conservation area to ensure buildings and the area is accessible to all.

1. The designation of the conservation area at Cresswell Quay will not prevent

Issue of impact of designation of conservation area and adaptations to make buildings accessible wasn't identified as issue or area of concern in terms of consultation responses.

2. Consultation

All households in the proposed designated Conservation Area were notified of the consultation by letter. Officers of the Authority held an engagement event at Pisgah Chapel. The venue was accessible to all, including those with a disability.

Local Development Plan 2 / Planning Process

See previous for Age in terms of reference to Local Development Plan 2 and Planning Process.

Census 2021 Data

	Output Area			
	W00003008	W00003008	W00002974	W00002974
Disability	#	%	#	%
Disabled under the Equality Act	49	21	55	18
Not disabled under the Equality Act	189	79	245	82
Total	238	100	300	100

Census 2021 Data				
	Output Area			
	W00003008	W00003008	W00002974	W00002974
Unpaid Care	#	%	#	%
Does not apply	15	6.28	9	3.00
Provides no unpaid care	205	85.77	254	84.67
Provides 19 or less hours unpaid care a week	8	3.35	18	6.00

adaptations to make buildings accessible, it will mean that when proposing an adaptation they will need to be of good design and sensitive to character and appearance of the conservation area.

2. The venue used for the engagement drop-in event was accessible to all.

	Provides 20 to 49 hours unpaid care a week Provides 50 or more hours unpaid care a week Total	2 9 239	0.84 3.77 100	7 12 300	2.33 4.00 100	
Gender Reassignment	<p>There is no potential impact on people with gender reassignment. No additional impacts identified through consultation activities.</p> <p>Local Development Plan 2 / Planning Process</p> <p>See previous for Age in terms of reference to Local Development Plan 2 and Planning Process.</p>					<p>No impact identified, no additional impacts identified through consultation activities.</p>
Pregnancy and Maternity	<p>There is no potential impact. No additional impacts identified through consultation activities.</p> <p>Local Development Plan 2 / Planning Process</p> <p>See previous for Age in terms of reference to Local Development Plan 2 and Planning Process.</p>					<p>No impact identified, no additional impacts identified through consultation activities.</p>
Race	<p>There is no potential impact. No additional impacts identified through consultation activities.</p> <p>Local Development Plan 2 / Planning Process</p> <p>See previous for Age in terms of reference to Local Development Plan 2 and Planning Process.</p> <p>Census 2021 Data</p>					<p>No impact identified, no additional impacts identified through consultation activities.</p>
	<div style="background-color: #cccccc; width: 100px; height: 15px; display: inline-block;"></div> Output Area					

	W00003008	W00003008	W00002974	W00002974											
Ethnic group	#	%	#	%											
Asian, Asian British or Asian Welsh	0	0	1	0.33											
Black, Black British, Black Welsh, Caribbean or African	0	0	1	0.33											
Mixed or Multiple ethnic groups	0	0	0	0											
White	238	100	299	99.34											
Total	238	100	301	100											
Protecting personal data: " Sometimes we need to make changes to data if it is possible to identify individuals. This is known as statistical disclosure control. In Census 2021, we: swapped records (targeted record swapping), for example, if a household was likely to be identified in datasets because it has unusual characteristics, we swapped the record with a similar one from a nearby small area (very unusual households could be swapped with one in a nearby local authority) added small changes to some counts (cell key perturbation), for example, we might change a count of four to a three or a five – this might make small differences between tables depending on how the data are broken down when we applied perturbation."															
Religion or Belief	<p>It will help maintain historical character of religious buildings within the conservation area. All households in the proposed designated Conservation Area were notified of the consultation by letter. An engagement event was held in Pysgah Chapel which was considered to be the most suitable venue out of the limited options available in Cresswell Quay. There are no village halls in Cresswell Quay and the local pub was considered to potentially be too busy during the summer period. No issues were raised regarding the use of the venue or the impact on religion or belief.</p> <p>Local Development Plan 2 / Planning Process</p> <p>See previous for Age in terms of reference to Local Development Plan 2 and Planning Process.</p> <p>Census 2021 Data</p> <table border="1"> <thead> <tr> <th></th> <th colspan="4">Output Area</th> </tr> </thead> <tbody> <tr> <td></td> <td>W00003008</td> <td>W00003008</td> <td>W00002974</td> <td>W00002974</td> </tr> </tbody> </table>					Output Area					W00003008	W00003008	W00002974	W00002974	<p>Will help maintain historical character of religious buildings within the conservation area.</p> <p>No additional impacts identified through consultation activities.</p>
	Output Area														
	W00003008	W00003008	W00002974	W00002974											

	Religion	#	%	#	%
	No religion	81	34.18	92	31.08
	Christian	139	58.65	188	63.51
	Buddhist	1	0.42	1	0.34
	Hindu	0	0	2	0.68
	Jewish	0	0	0	0
	Muslim	0	0	0	0
	Sikh	0	0	0	0
	Other religion	0	0	1	0.34
	Not answered	16	6.75	12	4.05
	Total	237	100	296	100

Protecting personal data: " Sometimes we need to make changes to data if it is possible to identify individuals. This is known as statistical disclosure control. In Census 2021, we: swapped records (targeted record swapping), for example, if a household was likely to be identified in datasets because it has unusual characteristics, we swapped the record with a similar one from a nearby small area (very unusual households could be swapped with one in a nearby local authority) added small changes to some counts (cell key perturbation), for example, we might change a count of four to a three or a five – this might make small differences between tables depending on how the data are broken down when we applied perturbation.

Sex	There is no potential impact. No additional impacts identified through consultation activities.				No impact identified, no additional impacts identified through consultation activities.
	Local Development Plan 2 / Planning Process				
	See previous for Age in terms of reference to Local Development Plan 2 and Planning Process.				
	Census 2021 Data				

	Output Area			
	W00003008	W00003008	W00002974	W00002974
Sex	#	%	#	%
Female	113	47.48	158	52.67

	Male	125	52.52	142	47.33		
	Total	238	100	300	100		
Sexual Orientation	There is no potential impact. No additional impacts identified through consultation activities.						No impact identified, no additional impacts identified through consultation activities.
	Local Development Plan 2 / Planning Process						
	See previous for Age in terms of reference to Local Development Plan 2 and Planning Process.						
Marriage and Civil Partnership	There is no potential impact. No additional impacts identified through consultation activities.						No impact identified, no additional impacts identified through consultation activities.
	Local Development Plan 2 / Planning Process						
	See previous for Age in terms of reference to Local Development Plan 2 and Planning Process.						
Socio economic disadvantage and inequalities of outcome (Equality Act 2010 context)	<p>1. Affordable Housing</p> <p>Designation of Conservation Area will not have impact on Affordable Housing development. The designation of a conservation area at Cresswell Quay would recognise the special architectural and historic interest of the village. All development must either preserve or enhance the character and appearance of the conservation area, this would include any affordable housing developments.</p> <p>2. Costs for Planning Applicants</p> <p>Permission is required for the demolition of certain buildings and structures in a conservation area. An application would be required to describe the proposed works and why they are required, and provide site and location plans and a structural survey. There is no fee for the application, however, the applicant may choose to appoint a planning</p>						Designation of Conservation Area will not have impact on Affordable Housing development. All development must either preserve or enhance the character and appearance of

	<p>agent to submit an application, and a structural survey would be required to be undertaken by a competent engineer or surveyor, however, it is likely a survey would be required in any case. A decision on whether to grant permission should be made by the Authority within 8 weeks. Due to the low number of applications, there would be a minimal impact on the Authority's resources.</p> <p>A notice for works to a tree in a conservation area should be given 6 weeks prior to work commencing. There is no fee for this application type. Information regarding the location, type and condition of the tree, description of proposed works and reason for the works and whether any replacement trees will be planted should be provided. This level of information would be likely to be provided by an applicant, however, applicants may choose to employ a planning agent which would incur a fee. Due to the low number of applications, there would be a minimal impact on the Authority's resources.</p> <p>All planning applications within a conservation area must demonstrate that development has preserved or enhanced the character or appearance of the conservation area. The designation helps to ensure that the form, scale, material and design of proposals would help to positively protect or enhance the area's unique character. The design standards are important and there may be some additional cost involved in design and materials, however, people value conservation areas and it could have a positive impact on house prices.</p>	<p>the conservation area, this would include any affordable housing developments.</p> <p>The designation does not result in additional costs to residents as applications regarding the demolition of buildings and structures or notification of works to trees do not incur a fee.</p> <p>There may be some additional costs involved in design and use of suitable materials in a Conservation Area, however the designation could have a positive impact on house prices.</p>
--	---	---

<p>Intersectionality considerations</p>	<p>No additional impacts identified through consultation activities.</p> <p>Local Development Plan 2 / Planning Process</p> <p>See previous for Age in terms of reference to Local Development Plan 2 and Planning Process.</p>	<p>See response in Age and Socio economic disadvantage and inequalities of outcome.</p>
<p>Health and Well-being Outcomes and Inequalities</p>	<p>1. Positive impact of conservation on well-being</p> <p>The conservation of buildings and heritage and protection of trees would have positive impacts on health and well-being. The introduction of controls over proposed works to trees would encourage their protection which directly benefits the natural environment and indirectly encourages healthier behaviours and increased physical activity levels. Protection of trees would also protect biodiversity and habitats. Trees also play a critical role in mitigating climate change through carbon sequestration, heat reduction, improving air and water quality and supporting biodiversity and ecosystem resilience.</p> <p>2. Traffic Safety</p> <p>Several comments received as part of the consultation voiced concerns over the increase of traffic and its impact on pedestrian safety in the area, particularly around the Quay. Traffic safety can be a particular area of concern in terms of safety of children.</p> <p>Assuming the proposed Conservation Area is adopted then a prime consideration in alterations to the highway will be whether the physical measures preserve or enhance the character or appearance of the conservation area, while meeting operational and safety requirements. This does not mean that things cannot change and improvements which help safety cannot be made but it does mean that the impact of the Conservation Area status should also be considered. The other designations which Cresswell Quay has,</p>	<p>Designation will help conserve heritage and trees with associated positive impacts linked to well-being.</p> <p>Assuming the proposed Conservation Area is adopted then a prime consideration in alterations to the highway will be whether the physical measures preserve or enhance the</p>

	<p>such as SSSI and Scheduled Ancient Monument status to the quay itself also bring with them environmental and conservation considerations which need to be borne in mind.</p> <p>3. Water Quality</p> <p>Issue of Water quality of the river effected by agricultural practices was highlighted in the consultation open-ended question at the end of the survey. Water quality and its monitoring is outside the remit for the Conservation Area Management Plan and instead is the responsibility of NRW.</p>	<p>character or appearance of the conservation area, while meeting operational and safety requirements.</p>
--	--	---

Public Sector Equality Duty Considerations

<p>How does the Strategic Plan, Policy or Decision being assessed promote equality of opportunity?</p>	<p>The engagement and consultation undertaken on the designation has allowed people the opportunity to influence what is happening in their community. The Conservation Area designation would also introduce a clear policy objective for development proposals to either preserve or enhance the character and appearance of the conservation area which is a clear and equitable policy objective.</p>
<p>How does the Strategic Plan, Policy or Decision promote good relations?</p>	<p>Consultation and engagement on the proposed designation and on individual applications for conservation area consent and planning applications would ensure representations are considered, thereby promoting good relations.</p> <p>The refusal of permission for conservation area consent or planning permission could cause bad feeling</p>
<p>Does this Strategic Plan, Policy or Decision have the potential to cause unlawful direct or indirect discrimination?</p>	<p>The main aim of the designation is to preserve or enhance the character and appearance of the conservation area.</p> <p>The designation of a Conservation Area at Cresswell Quay will introduce controls on demolition with the requirement to obtain Conservation Area Consent. The Authority is also required to be notified regarding proposed works to trees. All proposals for development are required to</p>

	<p>demonstrate that the development either preserves or enhances the character and appearance of the conservation area. This can be achieved with good design.</p> <p>In relation to submitting an application for Conservation Area Consent there would be a period of engagement with those affected. This means that the process of introducing a Conservation Area would: -</p> <ul style="list-style-type: none"> • reduce the probability of the discrimination caused when members of the public do not receive information about changes that affect them or who feel that they do not have the ability to influence. • require seeking the opinion of those who are affected. <p>The assessment of proposals could, however, lead to a refusal of consent. The planning system in Wales plays a crucial role in managing land use and development. Its purpose is to ensure the efficient and sustainable use of land while balancing the needs of development and conservation. This is particularly important in a National Park. Applicants can appeal the Authority's decision.</p> <p>The designation of the conservation area at Cresswell Quay will not prevent adaptations to make buildings accessible, it will mean that when proposing an adaptation, they will need to be of good design and sensitive to character and appearance of the conservation area.</p>
<p>Does this Strategic Plan, Policy or Decision have the potential to exclude certain group of people from obtaining services, or limit their participation in any aspect of public life?</p>	<p>Consultation on the proposed designation and on individual applications for conservation area consent and planning applications would ensure representations are considered promoting inclusivity. Pisgah Chapel was used for the drop-in style engagement event and was assessed to ensure it was accessible.</p>
<p>Will any of what is being assessed be wholly or partly carried out by contractors or in</p>	<p>Yes</p> <p>If yes, what steps will you put in place:</p> <ul style="list-style-type: none"> - Ensure the contractor has an Equal Opportunities and Diversity policy

<p>partnership with other organisations. If yes, what steps will you take to comply with the General Equality Duty in regard to procurement and/ or partnerships?</p>	<ul style="list-style-type: none"> - Requiring Exploratory Workshops and regular meetings as part of the commission - Requiring the preparation of an Integrated Impact Assessment of the proposal - Requiring papers to be prepared for workshops, Committee meetings including the preparation of reports of consultations on feedback from consultations carried out.
---	---

Data/ Engagement Gaps

<p>Do you have any data/ engagement gaps?</p>	<p>There are no identified data gaps. A map showing the proposed Conservation Area designation was sent with a letter informing residents and other identified stakeholders of the public consultation.</p> <p>17 consultation responses were received and have been considered by Officers and a Report of Consultation has been prepared. This will be reported to the National Park Authority to inform their final decision on the designation of a Conservation Area at Cresswell Quay. Appendix C Report of Consultations – provides an overview of public consultation response undertaken over an eight-week period from 30 July to 23 September 2024.</p> <p>A map of the designation will be circulated with a letter to notify of the designation. A notice will be published in the press and a press release and social media posts will be used to ensure there is suitable publicity of the designation.</p>
<p>If yes, can further information be obtained or additional engagement to fill any of these data gaps?</p>	<p>See previous answer.</p>

Equality/ Socio Economic Disadvantage and Inequality of Outcomes/ Health Inequalities and Outcomes - Summary/ Recommendation from Assessment to be included in Committee/ Leadership Team Report

Equality Summary/ Recommendation from Assessment:

Consultation and a community engagement event has taken place with the local community in Pisgah Chapel with an opportunity for questions and views invited on the area of the proposed Conservation Area designation. Information on the Conservation Area consultation was also promoted at events including The Pembroke Town and Country Show and the Pembrokeshire County Show during August.

The responses from the consultation and engagement have informed the final decision on the conservation area designation. A total of 17 responses were received to the consultation which were supportive of the Conservation Area designation. There was no opposition to the designation. A Report of Consultation has been prepared and will be published.

In relation to submitting an application for Conservation Area Consent there would be a period of engagement with those affected. This means that the process of introducing a Conservation Area would: -

- reduce the probability of the discrimination caused when members of the public do not receive information about changes that affect them or who feel that they do not have the ability to influence.
- require seeking the opinion of those who are affected.

The assessment of proposals could, however, lead to a refusal of consent. The planning system in Wales plays a crucial role in managing land use and development. Its purpose is to ensure the efficient and sustainable use of land while balancing the needs of development and conservation. This is particularly important in a National Park. Applicants can appeal the Authority's decision.

It will help maintain historical character of religious buildings within the conservation area.

The designation of the conservation area at Cresswell Quay will not prevent adaptations to make buildings accessible, it will mean that when proposing an adaptation, they will need to be of good design and sensitive to character and appearance of the conservation area.

Several comments received as part of the consultation voiced concerns over the increase of traffic and its impact on pedestrian safety in the area, particularly around the Quay. Traffic safety can be a particular area of concern in terms of safety of children.

Assuming the proposed Conservation Area is adopted then a prime consideration in alterations to the highway will be whether the physical measures preserve or enhance the character or appearance of the conservation area, while meeting operational and safety requirements. This does not mean that things cannot change and improvements which help safety cannot be made but it does mean that the impact of the Conservation Area status should also be considered. The other designations which Cresswell Quay has, such as SSSI and Scheduled Ancient Monument status to the quay itself also bring with them environmental and conservation considerations which need to be borne in mind.

Socio Economic Disadvantage and Inequality of Outcomes Summary/ Recommendation from Assessment:

Designation of Conservation Area will not have impact on Affordable Housing development. All development must either preserve or enhance the character and appearance of the conservation area, this would include any affordable housing developments.

There may be some additional cost for applicants in preparing an application for the demolition of certain buildings and structures in a conservation area, or for works involving trees. There is no fee for the applications, however, the applicant may require an agent to submit an application, and costs may be incurred in instructing an engineer or surveyor to undertake a structural survey, however, it is likely a survey would be required in any case.

All planning applications within a conservation area must demonstrate that development has preserved or enhanced the character or appearance of the conservation area. The design standards are important and there may be some additional cost involved in design and materials, however, people value conservation areas and it could have a positive impact on house prices.

Health Inequalities and Outcomes Summary/ Recommendation from Assessment:

Positive impact through the conservation of buildings and protection of trees which would have positive impacts on health and well-being.

Several comments received as part of the consultation voiced concerns over the increase of traffic and its impact on pedestrian safety in the area, particularly around the Quay. Traffic safety can be a particular area of concern in terms of safety of children. Assuming the proposed Conservation Area is adopted then a prime consideration in alterations to the highway will be whether the physical measures preserve or enhance the character or appearance of the conservation area, while meeting operational and

safety requirements. This does not mean that things cannot change and improvements which help safety cannot be made but it does mean that the impact of the Conservation Area status should also be considered. The other designations which Cresswell Quay has, such as SSSI and Scheduled Ancient Monument status to the quay itself also bring with them environmental and conservation considerations which need to be borne in mind.

Welsh Language

If it is not suitable to include detailed evidence information, data, and engagement/ consultation feedback in the table itself, please attach this information as an Appendix and make summary reference to them in the table when needed.

Area	Do you have evidence or reason to believe that this will or may impact on the Welsh Language in any of the following areas? Consider both positive and negative impacts. Reference relevant evidence and information from engagement feedback.	Response/ Mitigation/ Any additional actions needed
Use of Welsh Language	<p>Consultation Process</p> <p>The process of preparing and consulting on the Conservation Area designation has been carried out in accordance with the requirements of the Welsh Language Standards (Welsh Language Measure (Wales) 2011 with all information available bilingually.</p> <p>A specific question was included as part of the consultation on Welsh Language impact (question 6): “What effects (whether positive or adverse) do you think the proposed Conservation Area would have on the Welsh language, including opportunities for people to use Welsh and on treating the Welsh language no less favourably than English? How could positive effects be increased, or negative effects be mitigated?.” The process of designating Cresswell Quay a Conservation Area will also be carried out in accordance with the Welsh Language Standards.</p> <p>Question 6 Summary of Consultation Responses</p> <p>All respondents who participated in the survey provided a response for question six. Many respondents feel that there would be no effect to the Welsh Language if</p>	<p>Welsh Language Standards to be complied with.</p> <p>The Conservation Area Management Plan will be produced bilingually and available in Welsh and English on the website.</p> <p>Providing interpretation on site of the history of Cresswell Quay is not part of the Conservation Area appraisal we are currently carrying out, but</p>

the proposed Conservation area is designated. Four respondents feel that the implementation of bilingual signage at specific historical sites in Cresswell Quay will provide a positive addition to the area and will support the Welsh language. A few comments from respondents have suggested concerns regarding changing the town name to a Welsh translated name. One respondent feels unsure of the effects of the proposed Conservation Area on Welsh Language and another respondent did not suggest any viewpoint on this question.

Character

The proposed designation would preserve or enhance the character and appearance of the area. This would include the preservation and enhancement of buildings of special architectural and historic interest, thereby preserving the historic and cultural identity of an area, including Welsh traditions and heritage.

Census 2021 Data

	Output Area			
Speak Welsh	W00003008	W00003008	W00002974	W00002974
Aged 3 years or over: Cannot speak Welsh	201	87.39	266	90.17
Aged 3 years or over: Can speak Welsh	29	12.61	29	9.83
Total	230	100	295	100

	Output Area			
Welsh Language Skills	W00003008	W00003008	W00002974	W00002974
Can understand spoken Welsh only	18	7.79	13	4.39
Can speak, read and write Welsh	23	9.96	20	6.76

the suggestion will be raised within the PCNPA.

The proposed Conservation Area Management Plan will not affect any opportunities for Welsh speaking groups/learner groups to meet at the pub or arrange guided walks.

The importance of the local dialect is recognised, but it will not be affected by the Conservation Area Management Plan.

The Conservation Area Management Plan will not propose any name changes.

Positive that designation would preserve or enhance the character

	Can speak and other combinations of skills in Welsh	6	2.60	9	3.04	and appearance of the area.
	Other combination of skills in Welsh	3	1.30	12	4.05	
	No skills in Welsh	181	78.35	242	81.76	
	Total	231	100.00	296	100.00	
Number of Welsh Speakers	See above.					See above.
Fluency and Confidence of Welsh speakers and learners to use Welsh	See above.					See above.
Sustainability of Welsh Language Communities	<p>See above.</p> <p>Affordable Housing</p> <p>Designation of Conservation Area will not have impact on Affordable Housing development. The designation of a conservation area at Cresswell Quay would recognise the special architectural and historic interest of the village. All development must either preserve or enhance the character and appearance of the conservation area, this would include any affordable housing developments.</p> <p>Cresswell Quay is not in a Welsh Language-Sensitive Area (in terms of Local Development Plan 2)</p>					<p>See above.</p> <p>Affordable Housing: Designation of Conservation Area will not have impact on Affordable Housing development. All development must either preserve or enhance the character and appearance of the conservation area, this would include any affordable housing developments</p>

Welsh Language Standards	See above.	See above.
Other considerations	The designation of Cresswell Quay as a Conservation Area would preserve or enhance the cultural and historic buildings and assets in the area which may have Welsh language traditions.	

Data/ Engagement Gaps

Do you have any data/ engagement gaps?	<p>A Map showing the proposed designated Conservation Area was circulated with a letter to local residents and key stakeholders.</p> <p>17 consultation responses were received and have been considered by Officers and a Report of Consultation has been prepared. This will be reported to the National Park Authority to inform their final decision on the designation of a Conservation Area at Cresswell Quay.</p> <p>A specific question was included as part of the consultation on Welsh Language impact (question 6): “What effects (whether positive or adverse) do you think the proposed Conservation Area would have on the Welsh language, including opportunities for people to use Welsh and on treating the Welsh language no less favourably than English? How could positive effects be increased, or negative effects be mitigated?.” All respondents who participated in the survey provided a response for question six.</p>
If yes, can further information be obtained or additional engagement to fill any of these data gaps?	See above.

Welsh Language Summary/ Recommendation from Assessment:

The process of designating a conservation area has been carried out in accordance with the requirements of the Welsh Language Standards (Welsh Language Measure (Wales) 2011). The process of designating Cresswell Quay a Conservation Area will also be carried out in accordance with the Welsh Language Standards. The preservation and enhancement of buildings of special architectural and historic interest would preserve the historic and cultural identity of an area, including Welsh traditions and heritage.

Designation of Conservation Area will not have impact on Affordable Housing development. Cresswell Quay is not in a Welsh Language-Sensitive Area (in terms of Local Development Plan 2)

A specific question was included as part of the consultation on Welsh Language impact (question 6): “What effects (whether positive or adverse) do you think the proposed Conservation Area would have on the Welsh language, including opportunities for people to use Welsh and on treating the Welsh language no less favourably than English? How could positive effects be increased, or negative effects be mitigated?.” The process of designating Cresswell Quay a Conservation Area will also be carried out in accordance with the Welsh Language Standards. All respondents who participated in the survey provided a response for question six. Many respondents feel that there would be no effect to the Welsh Language if the proposed Conservation area is designated. Four respondents feel that the implementation of bilingual signage at specific historical sites in Cresswell Quay will provide a positive addition to the area and will support the Welsh language. A few comments from respondents have suggested concerns regarding changing the town name to a Welsh translated name. One respondent feels unsure of the effects of the proposed Conservation Area on Welsh Language and another respondent did not suggest any viewpoint on this question.

Officers provided the following response: The Conservation Area Management Plan will be produced bilingually and available in Welsh and English on the website. Providing interpretation on site of the history of Cresswell Quay is not part of the Conservation Area appraisal we are currently carrying out, but the suggestion will be raised within the PCNPA. The proposed Conservation Area Management Plan will not affect any opportunities for Welsh speaking groups/learner groups to meet at the pub or arrange guided walks. The importance of the local dialect is recognised, but it will not be affected by the Conservation Area Management Plan. The Conservation Area Management Plan will not propose any name changes.

Section 6 Biodiversity Duty and Decarbonisation

If it is not suitable to include detailed evidence information, data, and engagement/ consultation feedback in the table itself, please attach this information as an Appendix and make summary reference to them in the table when needed.

Please note: For National Park Management Plan and Local Development Plan separate Sustainability Appraisal (incorporating Strategic Environmental Assessments) are required.

Area	Do you have evidence or reason to believe that this will or may impact on the Biodiversity or Decarbonisation in any of the following areas? Consider both positive and negative impacts. Reference relevant evidence and information from engagement feedback.	Response/ Mitigation/ Any additional actions needed
Natural Environment - Biodiversity	<p>Designating a Conservation Area at Cresswell Quay would require prior notification for any works to trees. The introduction of controls over proposed works to trees would encourage their protection which directly protects biodiversity and habitats. Trees also play a critical role in mitigating climate change through carbon sequestration, heat reduction, improving air and water quality and supporting biodiversity and ecosystem resilience.</p> <p>Any development proposals in the Conservation Area would be required to demonstrate that the proposal would either preserve or enhance the character and appearance of the Conservation Area. In determining a planning application, the LPA would make decisions in accordance with the adopted development plan, comprising of Future Wales and the adopted Local Development Plan 2.</p> <p>The framework of the Local Development Plan 2 would be used to assess proposals, in particular Policy 10 Sites and Species of European Importance, Policy 11 Nationally Protected Sites and Species and Policy 12 Local Areas of Nature Conservation.</p>	<p>This is a positive outcome.</p> <p>Boundary Extension - Most of the area referred to is covered by TPOs, but the inclusion of the wooded area within the Conservation Area would provide additional protections and help protect the setting and the character of Cresswell Quay. Agree to amend boundary (see maps in the Appendix to the Report of Consultation showing the proposed Conservation Area boundary and the amended boundary following consultation).</p>

	<p>All public bodies must conserve biodiversity when carrying out their functions; historic areas and structures can be significant resources for biodiversity, providing important habitats, for example, for bats, birds and insects, lichens and other flora.</p> <p>Consultation Response – Boundary Area</p> <p>One comment was received by the questionnaire respondent who had stated the boundary line was not accurate in question three. They suggested an extension of the boundary to include an area of woodland subject to Tree Preservation Orders (TPOs) further down the estuary on the northern bank. The same view was expressed by an individual at the engagement event for Town and Community Councils. Most of the area referred to is covered by TPOs, but the inclusion of the wooded area within the Conservation Area would provide additional protections and help protect the setting and the character of Cresswell Quay. Agree to amend boundary (see maps in the Appendix to the Report of Consultation showing the proposed Conservation Area boundary and the amended boundary following consultation).</p>	
Natural Environment – Air, Land and Water Quality	<p>See above response.</p> <p>In terms of the LDP 2 framework, the following policies would be used to assess proposals; Policy 9 Light Pollution, Policy 12 which deals with Sites of Geological Interest, Policy 29 Sustainable Design, Policy 30 Amenity, Policy 31 Minimising Waste, Policy 32 Surface Water Drainage, Policy 34 Flooding and Coastal Inundation.</p>	This is a positive outcome.
Natural Environment – Access to Open and Green/ Blue Spaces	<p>See above response to Natural Environment - Biodiversity</p>	This is a balanced outcome ensuring that access is managed to avoid harm to the National Park.

Built Environment – Built Heritage	The designation would preserve or enhance the character and appearance of the area. This would include the preservation and enhancement of buildings of special architectural and historic interest, thereby preserving the historic and cultural identity of an area, including Welsh traditions and heritage.	This is a balanced outcome ensuring that the historic environment is not harmed.
CO2 Emissions or Mitigations	<p>Designating a Conservation Area at Cresswell Quay would require prior notification for any works to trees. The introduction of controls over proposed works to trees would encourage their protection. Trees also play a critical role in mitigating climate change through carbon sequestration, heat reduction, improving air and water quality and supporting biodiversity and ecosystem resilience.</p> <p>The need to promote energy efficiency will be balanced against the need to protect the character and appearance of the area when dealing with proposals for solar panels or other forms of microgeneration in Conservation Areas. Due to sensitivity of the Conservation Area to modern alternations, careful consideration would be given to the siting and design of solar panels or other forms of microgeneration. Equipment in prominent locations within the Conservation Area would require careful consideration and alternative locations to the rear of buildings should be considered.</p>	This is a balanced outcome ensuring that the historic environment is not harmed.
Co2e Sequestration / Storage	See above response to C02 Emissions or mitigations	This is a positive outcome.
Adapting to the effects of Climate Change	See above response to C02 Emissions or mitigations Proposals would be considered against the policies of the Local Development Plan 2 in particular, Policy 34 Flooding and Coastal Inundation and its supporting policies.	This is a positive outcome.
Resources Use – Energy efficiency and consumption	Impacts here are likely to be limited. See above for CO2 Emissions or Mitigations commentary.	Neutral impact.

Resources Use – Prevention, reduction, re- use, recovery, or recycling waste	No identified impact	No impact
Resource Use - Sustainable Procurement	No identified impact	No impact
Transport – Accessible Transport Provision	No identified impact	No impact
Transport – Sustainable Modes of Transport	No identified impact	No impact
Any other considerations	N/A	

Data/ Engagement Gaps

Do you have any data/ engagement gaps?	<p>A map showing the Conservation Area designation is shown in Appendix A.</p> <p>A Report of Consultation is attached at Appendix C.</p>
If yes, can further information be obtained or additional engagement to fill any of these data gaps?	See above.

Section 6 Biodiversity Duty and Decarbonisation - Summary/ Recommendation from Assessment to be included in Committee/ Leadership Team Report

Section 6 Biodiversity Duty and Decarbonisation Summary/ Recommendation from Assessment:

In summary the proposals are likely to have a positive effect on the Authority's biodiversity duty and can help protect trees that contribute to carbon sequestration. The need to promote energy efficiency will be balanced against the need to protect the character and appearance of the area when dealing with proposals for solar panels or other forms of microgeneration in Conservation Areas.

One comment was received by the questionnaire respondent who had stated the boundary line was not accurate in question three. They suggested an extension of the boundary to include an area of woodland subject to Tree Preservation Orders (TPOs) further down the estuary on the northern bank. The same view was expressed by an individual at the engagement event for Town and Community Councils. Most of the area referred to is covered by TPOs, but the inclusion of the wooded area within the Conservation Area would provide additional protections and help protect the setting and the character of Cresswell Quay. Agree to amend boundary (see maps in the Appendix to the Report of Consultation showing the proposed Conservation Area boundary and the amended boundary following consultation).

Consideration of 7 Well-being Goals for Wales and 5 Ways of Working under the Well-being of Future Generations (Wales) Act and any relevant future trends/ horizon scanning information

If it is not suitable to include detailed evidence information, data, and engagement/ consultation feedback in the table itself, please attach this information as an Appendix and make summary reference to them in the table when needed.

Well-being Goals/ Ways of Working	How have the following been taken into account? Reference relevant evidence and information from engagement feedback.	Response/ Mitigation/ Any additional actions needed
A Prosperous ² Park/ Pembrokeshire/ Wales	<p>Consultation Feedback</p> <p>Respondents have highlighted the importance of the pub and how it has maintained its historic character. Concerns that have previously been mentioned in question 6 were raised again in question seven. Increased noise, food outlets and advertisements in the area is mentioned as an area of concern that respondents are keen for the Authority to address as respondents feel this is negatively impacting Cresswell Quay.</p> <p>Any proposed commercialism of the area which would be subject to planning permission, would with a Conservation Area was in place, have to preserve or enhance the character or appearance of the conservation area as well as meet other planning requirements.</p> <p>The designation of a conservation area at Cresswell Quay would recognise the special architectural and historic interest of the village and would ensure that future development either preserves or enhances the character and appearance of the conservation area. Retaining its character will support the areas recreational, visitor and community experience.</p>	Any proposed commercialism of the area which would be subject to planning permission, would with a Conservation Area was in place, have to preserve or enhance the character or appearance of the conservation area as well as meet other planning requirements.
A Resilient ³ Park/ Pembrokeshire / Wales	Please see commentary under ‘Section 6 Biodiversity and Decarbonisation duty’	A positive impact

² An innovative, productive, and low carbon society which recognises the limits of the global environment and therefore uses resources efficiently and proportionately (including acting on climate change); and which develops a skilled and well-educated population in an economy which generates wealth and provides employment opportunities, allowing people to take advantage of the wealth generated through securing decent work.

³ A nation which maintains and enhances a biodiverse natural environment with healthy functioning ecosystems that support social, economic, and ecological resilience and the capacity to adapt to change (for example, climate change).

A Healthier ⁴ Park/ Pembrokeshire / Wales	Please see commentary under 'Health and Well-being Outcomes and Inequalities'	A positive impact
A More Equal ⁵ Park/ Pembrokeshire / Wales	The potential impact is positive. See commentary under Equality section. '	A positive impact
A Park/ Pembrokeshire/ Wales of Cohesive ⁶ Communities	The potential impact is positive. Properly protected and enhanced conservation areas can improve the quality of life and well-being for everyone.	Positive Impact.
A Park/ Pembrokeshire / Wales of Vibrant Culture & Thriving Welsh Language ⁷	The potential impact is positive. The designation of a conservation area would promote and protect buildings of architectural and historic interest, thereby protecting culture, heritage and Welsh traditions. There are clear synergies between the specific duty to preserve or enhance conservation areas, as required by the 1990 Act, and the general duty to promote and protect heritage, as set out in the 2015 Act. Properly protected and enhanced conservation areas can improve the quality of life and well-being for everyone.	Positive Impact.
A Globally Responsible ⁸ Park/ Pembrokeshire / Wales	The conservation area designation would preserve or enhance the special historic or architectural interest of an area, thereby, being responsible in preserving historic assets for future generations.	Positive outcome
Long Term ⁹	The conservation area designation considers the long term impact of proposals and is required to preserve or enhance the special historic or	Positive outcome.

⁴ A society in which people's physical and mental well-being is maximised and in which choices and behaviours that benefit future health are understood.

⁵ A society that enables people to fulfil their potential no matter what their background or circumstances (including their socio-economic background and circumstances).

⁶ Attractive, viable, safe, and well-connected communities.

⁷ A society that promotes and protects culture, heritage, and the Welsh language, and which encourages people to participate in the arts, and sports and recreation.

⁸ A nation which, when doing anything to improve the economic, social, environmental, and cultural well-being of Wales, takes account of whether doing such a thing may make a positive contribution to global well-being.

⁹ The importance of balancing short-term needs with the need to safeguard the ability to also meet long-term needs.

	architectural interest of an area, thereby, being responsible in preserving historic assets for future generations.	
Prevention ¹⁰	The conservation area designation prevents development that would neither preserve nor enhance the special historic or architectural interest of an area.	Positive outcome.
Integration ¹¹	<p>The proposed Conservation Area designation would align with a number of identified Special Qualities of the Pembrokeshire Coast National Park of: cultural heritage, rich historic environment, distinct settlement character and richness of habitats and biodiversity.</p> <p>The National Park Authority's Corporate and Resources Plan 2023 to 2027 identifies priorities in relation to:</p> <ul style="list-style-type: none"> - Boosting biodiversity and halting its decline - Destination Net Zero for the National Park - People being healthier and happier and more connected to nature and heritage. - People have a chance to live work and enjoy the National Park 	The assessment has identified positive impacts in terms of biodiversity and contributions towards mitigating carbon emissions, ensuring greater inclusivity in decision making are also identified.
Collaboration ¹²	<p>The designation of a conservation area at Cresswell Quay has been consulted on with the local community and stakeholders. The Authority held a drop in engagement event in the local community to discuss any concerns and answer questions. Key stakeholders, such as Cadw were consulted. Positive and supportive responses were received to the proposed designation. A Report of Consultation is attached at Appendix C.</p> <p>A Conservation Area Appraisal and Management Plan is being prepared and will be consulted upon in early 2025.</p>	Collaboration undertaken and will continue with the draft Conservation Area Appraisal and Management Plan.

¹⁰ How acting to prevent problems occurring or getting worse may help public bodies meet their objectives.

¹¹ Considering how the public body's well-being objectives may impact upon each of the well-being goals, on their other objectives, or on the objectives of other public bodies.

¹² Acting in collaboration with any other person (or different parts of the body itself) that could help the body to meet its well-being objectives.

Involvement ¹³	An initial meeting took place with the local Town and Community Councils at Carew, Martletwy and Jeffreyston. The Authority held a drop in engagement event in the local community and officers attended local shows in August to involve the local community and stakeholders. The responses received have informed the decision and a Report of Consultation is attached at Appendix C. A Conservation Area Appraisal and Management Plan is being prepared and will be consulted upon in early 2025.	Involvement undertaken and will continue with the Conservation Area Appraisal and Management Plan.
Horizon Scanning – Future Trends Considerations	There will be a need to monitor future development and review the Cresswell Quay Conservation Area, if progressed.	To be reviewed.

WFG: 7 Well-being Goals for Wales / 5 Ways of Working and Future Trends/ Horizon Scanning summary/ recommendation from Assessment:

<p>WFG: 7 Well-being Goals for Wales / 5 Ways of Working and Future Trends/ Horizon Scanning Summary/ Recommendation from Assessment:</p> <p>The proposals fit well within the Well-being Goals and the 5 Ways of Working.</p>
--

Section 4 – Follow up Actions – for inclusion in Integrated Assessment Log for Monitoring

Action	Responsible Officer	Timescales
Welsh Language Standards to be complied with during preparation and approval process.	Sara Morris	Ongoing

Please forward completed integrated assessments to mairt@pembrokeshirecoast.org.uk

¹³ The importance of involving people with an interest in achieving the well-being goals and ensuring that those people reflect the diversity of the area which the body serves.